

# Technical Specifications

## YGEV2-2pin Series Electrical Connectors

### • Product Overview

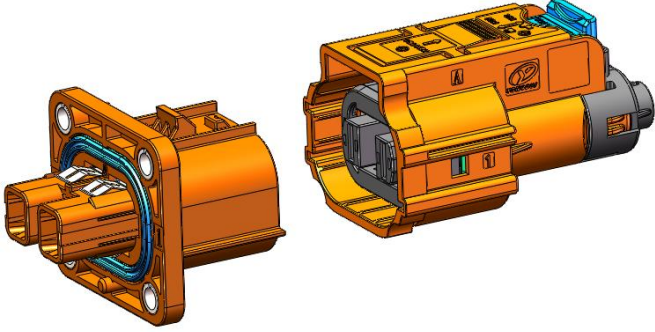







 <p><b>Application Scenario</b></p> <p>Suitable for electrical connections of electric vehicle air-conditioning compressors, PTCs, chargers, DCDCs, high-voltage boxes, etc.</p>	<p><b>Advantages</b></p> <ul style="list-style-type: none"> <li>✓ The product can achieve 360-degree full shielding;</li> <li>✓ The product can realize secondary interlocking and unlocking;</li> <li>✓ The product has a delayed high voltage interlocking function;</li> <li>✓ Different combinations of key positions at both ends are used to prevent wrong insertion;</li> <li>✓ The connection between the plug and the receptacle is straight-insertion locking;</li> <li>✓ Plugs and receptacles use terminal crimping.</li> </ul>
---	---

### • Ordering Information

Ordering information (assembly)						
Key position	A	B	A	B	A	B
Product Name	YGEV2-S2PA plug (2.5mm <sup>2</sup> )	YGEV2-S2PB plug (2.5mm <sup>2</sup> )	YGEV2-S2PA plug (4mm <sup>2</sup> )	YGEV2-S2PB plug (4mm <sup>2</sup> )	YGEV2-S2PA plug (6mm <sup>2</sup> )	YGEV2-S2PB plug (6mm <sup>2</sup> )
Part No.	111000405745	111000405750	111000405744	111000405751	111000405743	111000405752
Product Name	YGEV2-P2RA receptacle (2.5mm <sup>2</sup> )	YGEV2-P2RB receptacle (2.5mm <sup>2</sup> )	YGEV2-P2RA receptacle (4-6mm <sup>2</sup> )	YGEV2-P2RB receptacle (4-6mm <sup>2</sup> )	YGEV2-P2RA receptacle (4-6mm <sup>2</sup> )	YGEV2-P2RB receptacle (4-6mm <sup>2</sup> )
Part No.	111000502824	111000502826	111000502823	111000502827	111000502823	111000502827

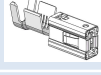
Ordering information (assembly)	Ordering information (parts details, can be purchased separately)				
	Product Name	Part No.	Qty	Wiring specifications	Diagram (reference)



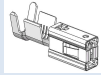

YGEV2-S2PA plug (2.5mm <sup>2</sup> )	111000405745	YGEV2-S2PA plug assembly	112010106228	1	/	
		5.8×0.8socket ( 2.5mm <sup>2</sup> )	110010400999	2	2.5mm <sup>2</sup> (LV216) Φ4.7 (0, -0.5) mm	
		YG1467 shielding part-outer-4	114022500495	2		
		YGEV2 shielding- inner-2.5	114022500523	2		
		YGEV2 baffle-1-Φ5	114019801833	2		
		YGEV2-1 sealing body-Φ2.6	114050502112	2		
		Φ5.1 tail cover (black)-2	114069805485	1		
YGEV2-S2PB plug (2.5mm <sup>2</sup> )	111000405750	YGEV2-S2PB plug assembly	112010105914	1		/
		5.8×0.8socket ( 2.5mm <sup>2</sup> )	110010400999	2	2.5mm <sup>2</sup> (LV216) Φ4.7 (0, -0.5) mm	
		YG1467 shielding part-outer-4	114022500495	2		
		YGEV2 shielding- inner-2.5	114022500523	2		
		YGEV2 baffle-1-Φ5	114019801833	2		
		YGEV2-1 sealing body-Φ2.6	114050502112	2		
		Φ5.1 tail cover (black)-2	114069805485	1		

Ordering information (assembly)		Ordering information (parts details, can be purchased separately)				
		Product Name	Part No.	Qty	Wiring specifications	Diagram (reference)
YGEV2-S2PA plug (4mm <sup>2</sup> )	111000405744	YGEV2-S2PA plug assembly	112010106228	1	/	
		5.8×0.8socket (4~6mm <sup>2</sup> )	501021401790	2	4mm <sup>2</sup> (LV216) Φ5.8 (0, -0.5) mm	
		YG1467 shielding part-outer-4	114022500495	2		
		YG1467 shielding part-inner-4	114022500492	2		
		YGEV2 baffle-1-Φ6.1	114019801830	2		
		YGEV2-1 sealing body-Φ3.9	114050501799	2		
		Φ5.8 tail cover (black)-2	114069805482	1		
YGEV2-S2PB plug (4mm <sup>2</sup> )	111000405751	YGEV2-S2PB plug assembly	112010105914	1		/
		5.8×0.8socket (4~6mm <sup>2</sup> )	501021401790	2	4mm <sup>2</sup> (LV216) Φ5.8 (0, -0.5) mm	
		YG1467 shielding part-outer-4	114022500495	2		
		YG1467 shielding part-inner-4	114022500492	2		
		YGEV2 baffle-1-Φ6.1	114019801830	2		
		YGEV2-1 sealing body-Φ3.9	114050501799	2		
		Φ5.8 tail cover (black)-2	114069805482	1		

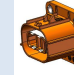
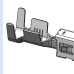
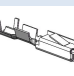
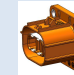
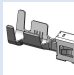
Ordering information (assembly)		Ordering information (parts details, can be purchased separately)				
		Product Name	Part No.	Qty	Wiring specifications	Diagram (reference)
YGEV2-S2PA plug (6mm <sup>2</sup> )	111000405743	YGEV2-S2PA plug assembly	112010106228	1	/	
		5.8×0.8socket (4~6mm <sup>2</sup> )	501021401790	2	6mm <sup>2</sup> (LV216) Φ6.5 (0, -0.5) mm	

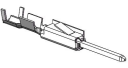
		YG1467 shielding part-outer-6	114022500496	2		
		YG1467 shielding part-inner-6	114022500494	2		
		YGEV2 baffle-1-Φ6.8	114019801815	2		
		YGEV2-1 sealing body-Φ4.8	114050501765	2		
		Φ6.5 tail cover (black)-2	114069805324	1		
YGEV2-S2PB plug (6mm <sup>2</sup> )	111000405752	YGEV2-S2PB plug assembly	112010105914	1	/	
		5.8×0.8socket (4~6mm <sup>2</sup> )	501021401790	2	6mm <sup>2</sup> (LV216) Φ6.5 (0, -0.5) mm	
		YG1467 shielding part-outer-6	114022500496	2		
		YG1467 shielding part-inner-6	114022500494	2		
		YGEV2 baffle-1-Φ6.8	114019801815	2		
		YGEV2-1 sealing body-Φ4.8	114050501765	2		
		Φ6.5 tail cover (black)-2	114069805324	1		

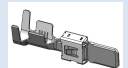
Ordering information (assembly)		Ordering information (parts details, can be purchased separately)				
		Product Name	Part No.	Qty	Wiring specifications	Diagram (reference)
YGEV2-P2RA receptacle (2.5mm <sup>2</sup> )	111000502824	YGEV2-P2RA receptacle assembly	112020107025	1	/	
		5.8×0.8 pin ( 2.5mm <sup>2</sup> )	110010400760	2	Φ3.5±0.2mm (2.5mm <sup>2</sup> )	
		0.63×0.63 pin	110010401011	2	Φ1.3±0.1mm (0.35mm <sup>2</sup> )	
YGEV2-P2RB receptacle (2.5mm <sup>2</sup> )	111000502826	YGEV2-P2RB receptacle assembly	112020106703	1	/	
		5.8×0.8 pin ( 2.5mm <sup>2</sup> )	110010400760	2	Φ3.5±0.2mm (2.5mm <sup>2</sup> )	

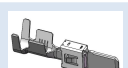
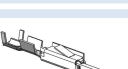
		0.63×0.63 pin	110010401011	2	Φ1.3±0.1mm (0.35mm <sup>2</sup> )	
YGEV2-P2RA receptacle (4-6mm <sup>2</sup> )	111000502823	YGEV2-P2RA receptacle assembly	112020107025	1	/	
		5.8×0.8 pin (4~ 6mm <sup>2</sup> )	501021401626	2	Φ4.5±0.2mm (4mm <sup>2</sup> ) Φ4.9±0.2mm (6mm <sup>2</sup> )	
		0.63×0.63 pin	110010401011	2	Φ1.3±0.1mm (0.35mm <sup>2</sup> )	
YGEV2-P2RB receptacle (4-6mm <sup>2</sup> )	111000502827	YGEV2-P2RB receptacle assembly	112020106703	1	/	
		5.8×0.8 pin (4~ 6mm <sup>2</sup> )	501021401626	2	Φ4.5±0.2mm (4mm <sup>2</sup> ) Φ4.9±0.2mm (6mm <sup>2</sup> )	
		0.63×0.63 pin	110010401011	2	Φ1.3±0.1mm (0.35mm <sup>2</sup> )	

## • Technical Data

Basic Information	
PIN distance	12.8mm
Number of cores	2pin
Cable specifications	Plug end: 2.5mm <sup>2</sup> (LV216)/Φ4.7 (0,-0.5)mm 4mm <sup>2</sup> (LV216)/Φ5.8 (0,-0.5)mm 6mm <sup>2</sup> (LV216)/Φ6.5 (0,-0.5)mm Socket end: 2.5mm <sup>2</sup> (GB)/Φ3.5±0.2mm 4mm <sup>2</sup> (GB)/Φ4.5±0.2mm 6mm <sup>2</sup> (GB)/Φ4.9±0.2mm 0.35mm <sup>2</sup> /Φ1.3±0.1mm
Outlet direction	180°

Electrical properties	
Rated voltage	1000 V (power), 24 V (signal)
Rated current	20A (2.5mm <sup>2</sup> ), 32A (4mm <sup>2</sup> ), 40A (6mm <sup>2</sup> )
Withstand voltage	3000 V (power), 1000 V (signal) (50Hz AC normal)
Insulation resistance	≥100MΩ (power/signal) (1000V DC)
HVIL (Y/N)	Y
Shield (Y/N)	Y

Mechanical properties	
Mechanical life	≥50 times

Vibration level	S2 (LV214)
-----------------	------------

Environmental resistance	
Operating temperature	-40°C ~ +125°C
Protection level	IP67&IP6K9K (header plug-in)
Relative humidity	95% (at 40°C)
Salt spray level	96h
Altitude	≤4000m

Material/Coating/Appearance
See Parts Drawing

Standards and Certification	
Flame retardant grade	UL94 V-0 (plastic), HB (rubber)
Environmental requirements	RoHS 2.0
Implementation Standards	USCAR 37 (Aug 2008)

For other technical data, please refer to the DV/PV test report

• Dimensions

**YGEV2-S2P series plug assembly appearance** (tolerance not specified:  $\pm 0.5$ )

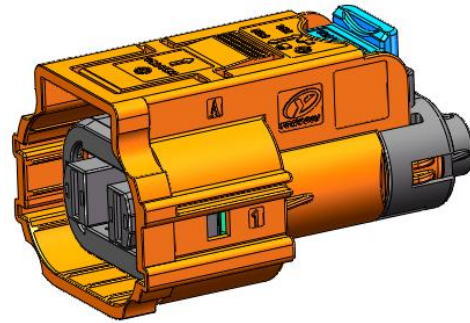
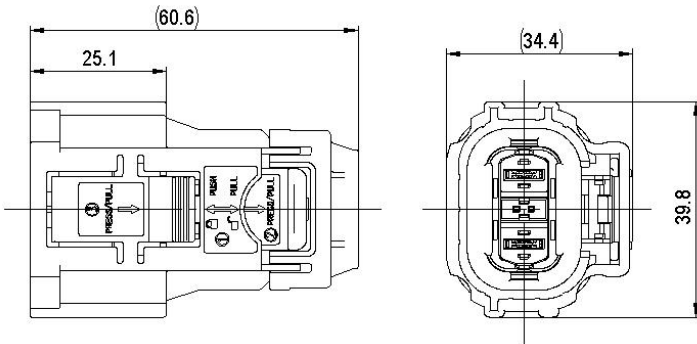

型号	YGEV2-S2PA插头	YGEV2-S2PB插头
键位	A	B
对插键位图示		

**YGEV2-P2R series socket assembly appearance** (tolerance not specified:  $\pm 0.5$ )

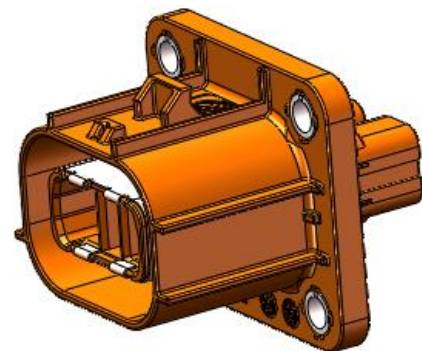
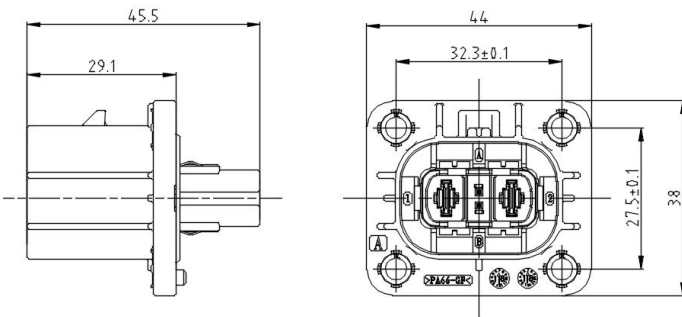

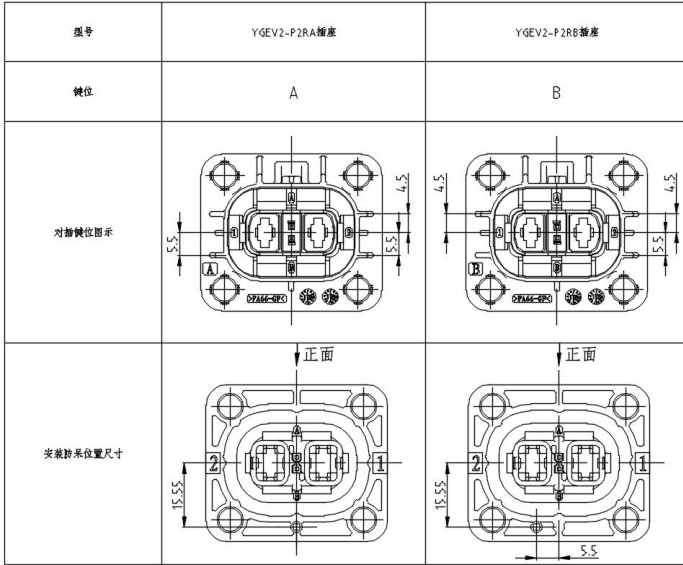

YGEV2-P2R series socket installation hole dimensions (tolerance not specified:  $\pm 0.1$ )

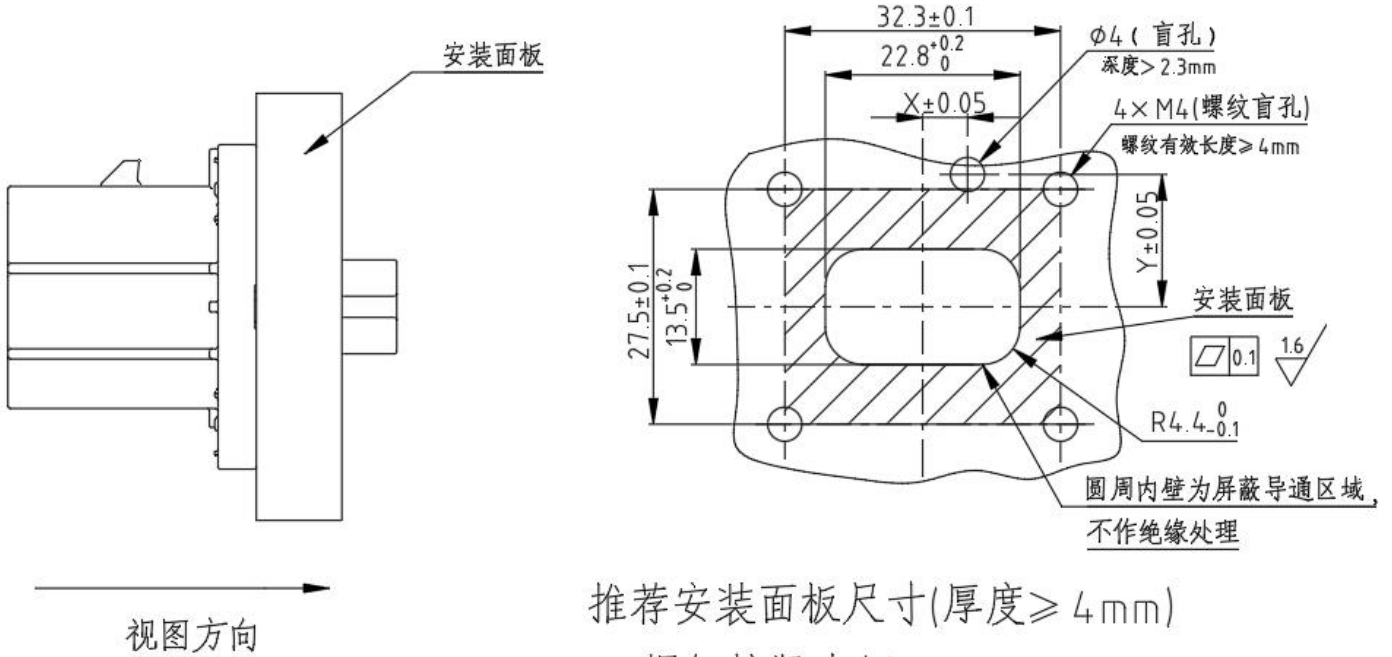

型号	X	Y	备注
YGEV2-P2RA	0	-15.55	防错凸台孔位尺寸按图示
YGEV2-P2RB	5.50	-15.55	



## • Installation Introduction

Special tools	
Removal tools	Power pin removal auxiliary tool (532031201008) Powersocket removal aid tool (532031201010) Signal pin removal auxiliary tool (532031201009)
Needle feeding tool	/
Crimping tools	/
Other Tools	/

## • Store

Packaging Storage/Transportation Instructions	
Storage requirements	Contact parts (gold-plated, silver-plated) must be stored separately, kept neat, clean and ventilated. The storage environment should be controlled at a humidity of $\leq 60\%$ and a temperature of 5 ~ 30°C. Reference shelf life 6 months
Transshipment requirements	During packaging, transportation, transfer, production and assembly, the terminals should be protected from collision, contact with corrosive gases and liquids, and direct contact with hands, etc., to ensure that the terminal contact surface is in good condition.